

Chepstow Society – Town Planning Roundup for March 2021

Simon Maddison, 26th March 2021

Introduction

This is an updated summary of a selection of recent planning applications and decisions. Some are still in progress and some have been decided for a while. This includes some developments that I did not include last month, and a couple of updates.

I have chosen these on the basis of their impact to the town, in terms of character and street and townscape. They are (mainly) listed in order of date of approval. Apart from the photographs, all material has been taken from the MCC planning portal.

Hardwick Hill

DM/2021/00300 | The development of a residential apartment building of four flats with associated external works including driveway, parking and garden provision. | Land To The North-West Of Hardwick Cottage Rockwood Road Chepstow NP16 5DT

This plan, which has been submitted for consideration, is for the development of a steeply sloping field just off Hardwick Hill, shown in Red, adjacent to Ashfield. The blue outline is Hardwick Cottage.

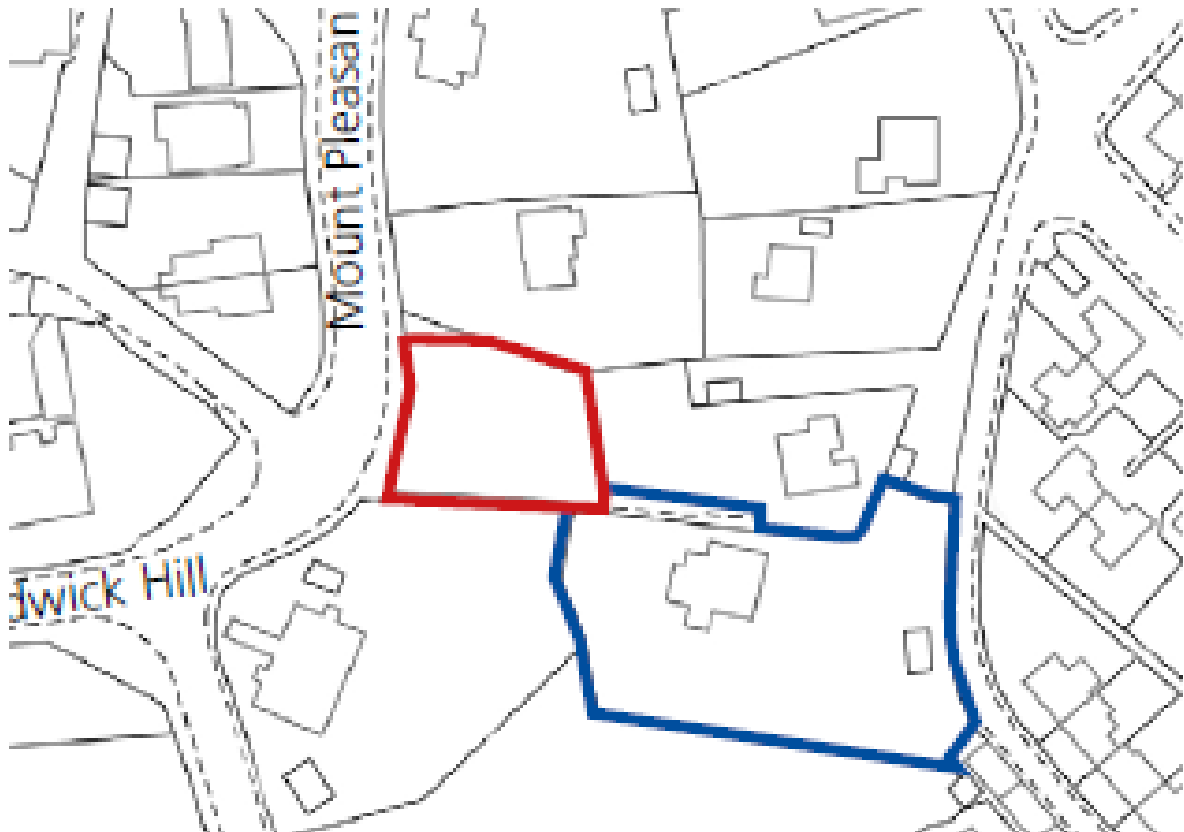

This is a challenging location.

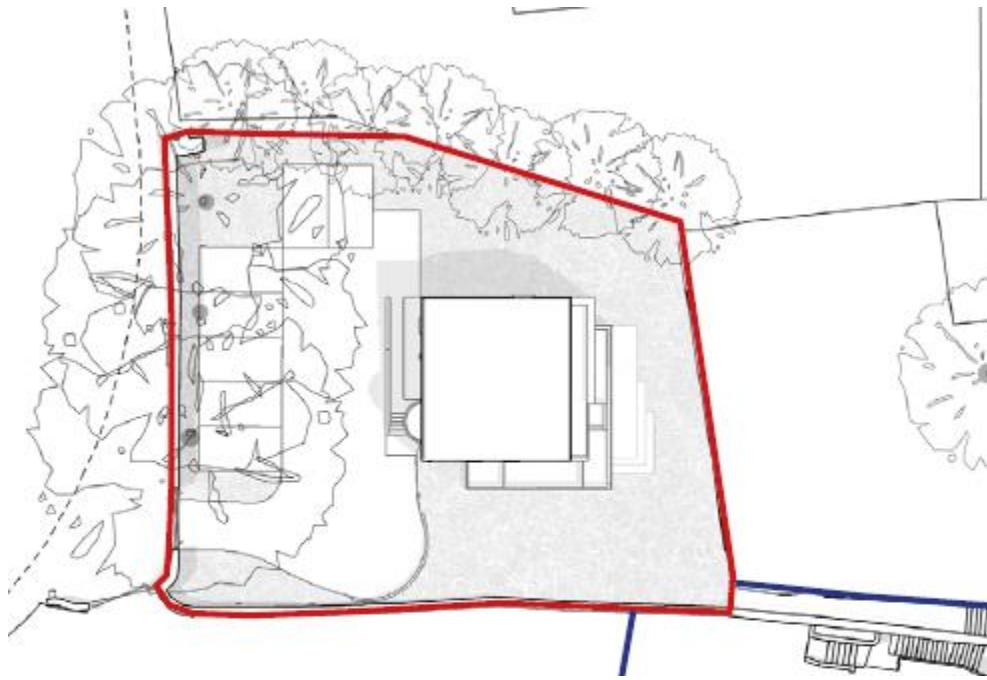

+7.9m ridge line





North Elevation

Hazelton, Bayfield

DC/2017/00011. This relates to the detail of DC/2014/01538 which was the original application. This covers 3 houses on a piece of land adjacent to the farm and adjacent to the green walkway. Work on plot 1 is now well advanced.

